

Adjustable Beam Clamp Model BC



Main Features

- Range from 1.0t to 10.0t.
- Quick and versatile rigging point for hoisting equipment.
- Low headroom because of the built in anchor point.
- Highly flexible – for lifting, pulling or as an anchor point.
- Multidirectional adjusting screw spindle ensures a high clamping force to the various flange sizes within its capacity.
- Wide beam flange adjustment range – Beam width range 75mm to 350mm.
- Operating temperature of -50°C to +50°C.
- 5:1 factor of safety.
- Optional locking device.

These units meet and exceed all the requirements within BS EN 13155:2003, A2:2009 and AS4991.

Certification:

Each unit comes fully certified with a test certificate or an EC Declaration of Conformity stating compliance with the essential health and safety requirements of the Machinery Directive 2006/42/EC.

Product Code	Capacity (tonne)	Dimensions (mm)								Net Weight (kg)
		A	B	C	D	E	F	G	ØJ	
BC-0100	1	75-210	182-328	77	26	190	144-117	52-38	Ø20	4
BC-0200	2	75-210	182-328	85	26	190	144-117	52-38	Ø20	4.5
BC-0300	3	75-305	214-460	107	35	240	224-179	58-40	Ø22	8
BC-0500	5	75-305	214-460	121	35	240	224-175	58-40	Ø28	10
BCF-1000	10	120-350	295-510	182	36	300	222-171	71-54	Ø43	24.5

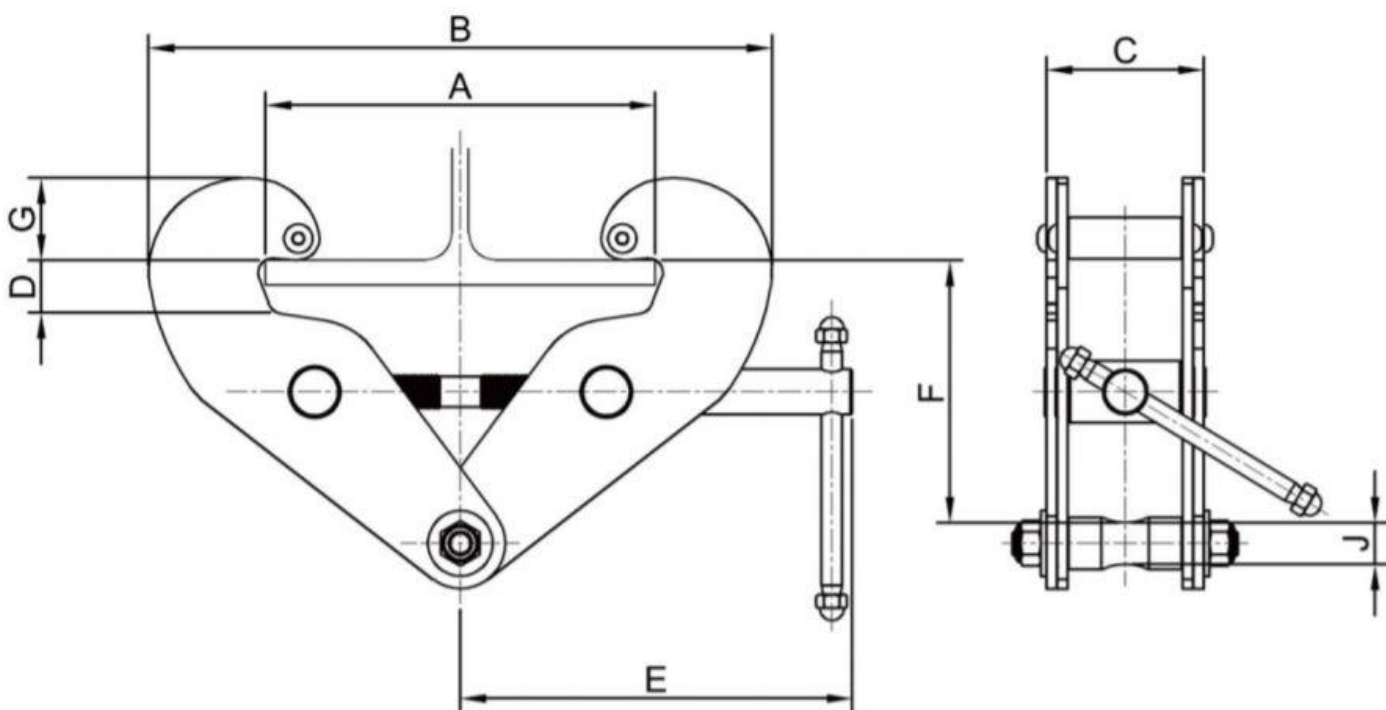

Due to our continual product development, dimensions, weights and specifications may change without prior notice. Please check with our sales team when ordering.

01489 878769 ■ sales@mcengineeringsservices.com ■ www.mcengineeringsservices.com

